

Create an activity map

Published: 2019-02-08

An activity map is an interactive 2D or 3D display of real-time device connections based on protocol activity between devices. Activity maps help you visualize traffic flows and kick off troubleshooting based on an interesting data point in a map.

You can create an activity map for an active single device, a device group, or an activity group. After generating a basic map, you can then filter devices and connections in your map.

 **Note:** You cannot create an activity map for an L2 device (which only has a MAC address associated with it) or for an L3 device in limited analysis. Make sure that you select a device with full L4-L7 metrics. For more information about L2 devices, L3 devices, and limited analysis, see the [Device Discovery FAQ](#).

Create a basic map

A basic activity map shows you a single step, or level, of device connections between origin devices and peer devices on your network.

1. Log into the Web UI on a Discover or Command appliance.
2. To create a map for a device, device group, or activity group, complete one of the following steps:
 - a) Click **Devices** in the left pane and then click an individual device name.

 **Note:** You cannot create an activity map for an L2 device (which only has a MAC address associated with it) or for an L3 device in limited analysis. Make sure that you select a device in full analysis.

- b) Click **Activity Groups** in the left pane and then click an activity group name.
 - c) Click **Device Groups** in the left pane and then click a device group name.
3. In the View section in upper right corner of the page, click **Activity Map**.

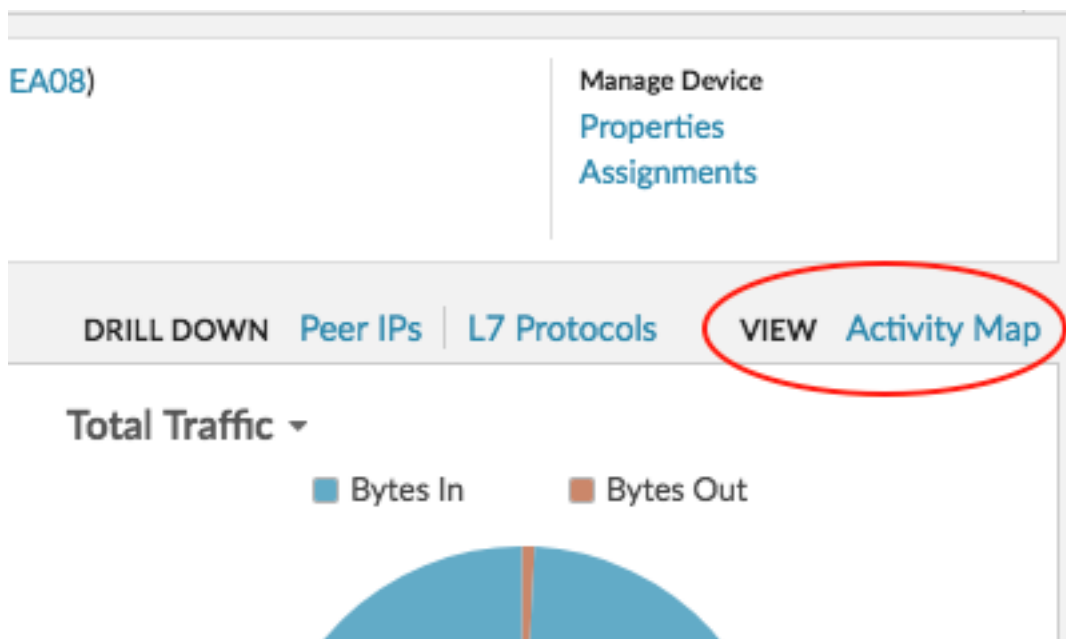

4. An activity map opens and displays the device or group as the origin device, and all of their connections to peer devices.

5. Filter connections by protocol activity by completing the following steps:
 - a) Click the drop-down list in the Step 1 section of the left pane, as shown in the following figure.

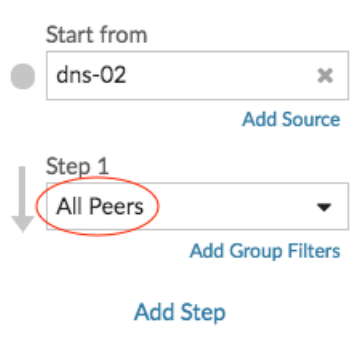

- b) At the top of the drop-down list, search for and select a protocol activity and role. You can make more than one selection.
 - c) Click anywhere outside of the drop-down list.
6. Optional: Change the primary origin device by completing the following steps:
 - a) In the Start from section in the left pane, click the device or group name. A drop-down list appears.

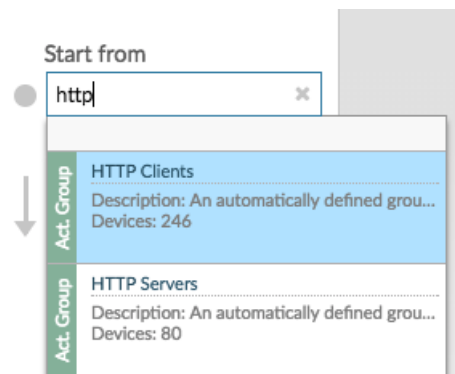

- b) Search for and select another device or group to dynamically update the map origin for the map you are viewing.
7. Optional: Create an ad hoc group of sources to quickly investigate traffic originating from multiple devices in the same map. Click **Add Source**.

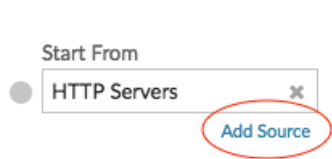

 **Note:** If you select a device, activity group, or device group with no protocol activity associated with it, an activity map will appear without any data.

Add connections and filter devices in your map

To better understand the path of traffic from origin devices to downstream devices, you can add more steps to your map. You can also create filters to include or exclude devices from the map. The following figure shows you how to add steps and create filters.

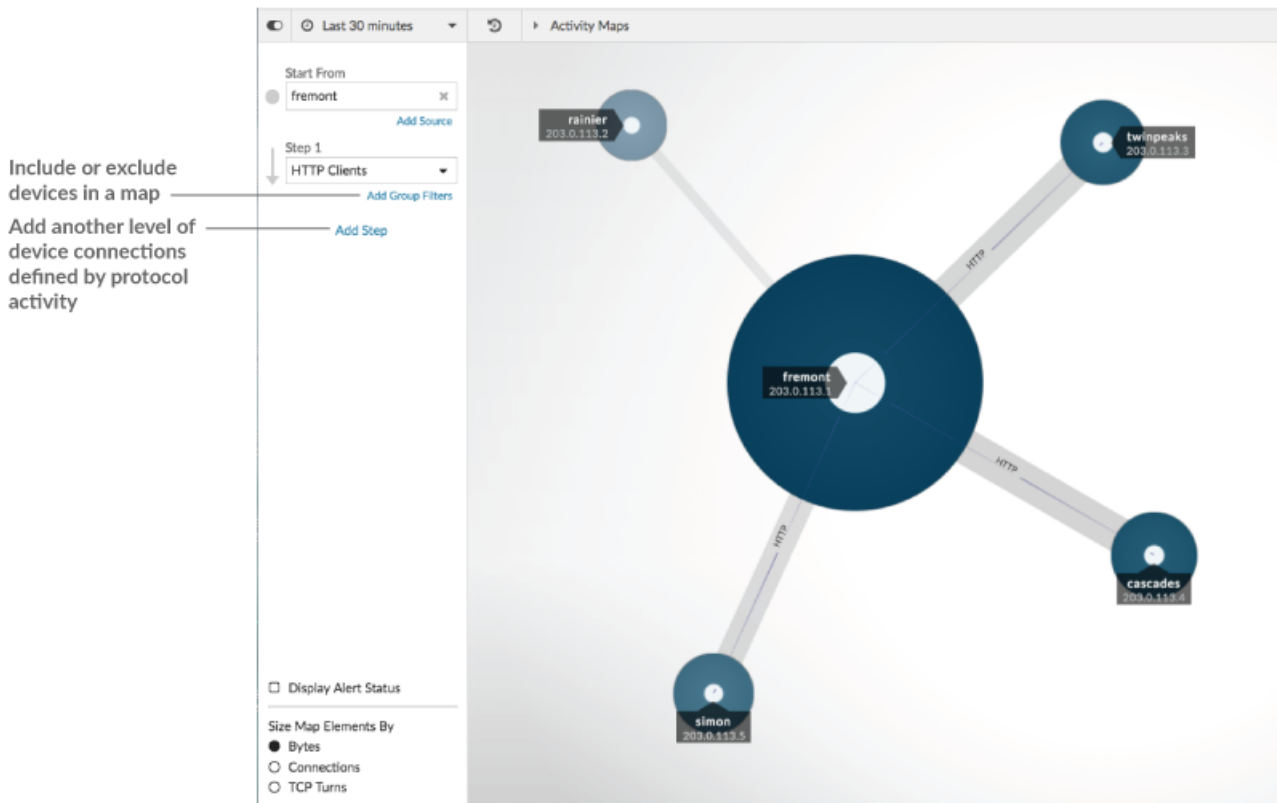

Add another level of device connections

A step defines a level of connection between devices in a map. Devices in each step have a relationship to the devices in the previous step. These relationships are defined by their protocol activity. You can add up to 5 steps to see how traffic flows from one device to another.

1. Click **Add Step**, as shown in the following figure. **All Peers** is selected by default.

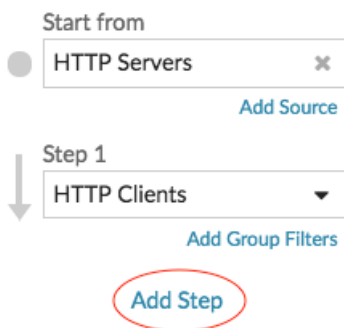

- At the top of the drop-down list, search for and select a protocol activity and role. You can make more than one selection.

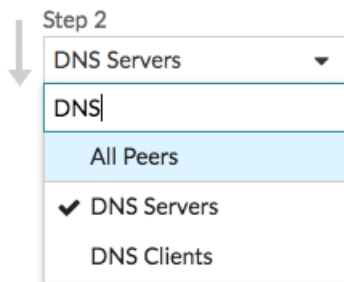

- Click anywhere outside of the drop-down list.

Include or exclude devices

You can filter devices within a step by their device group or activity group membership.

- Click **Add Group Filter**.

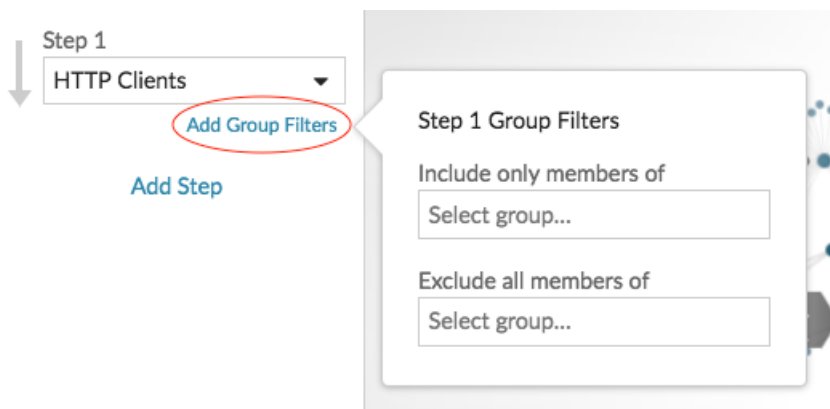

- Click a drop-down list to search for and select a device group or activity group.
- Click anywhere outside of the filter menu to apply your filters.
- To remove or change a filter, complete the following steps:
 - Click the device group name.



- Change the filter by clicking the drop-down list and then selecting another device group.
- Remove the filter by clicking the **x** icon, as shown in the following figure.

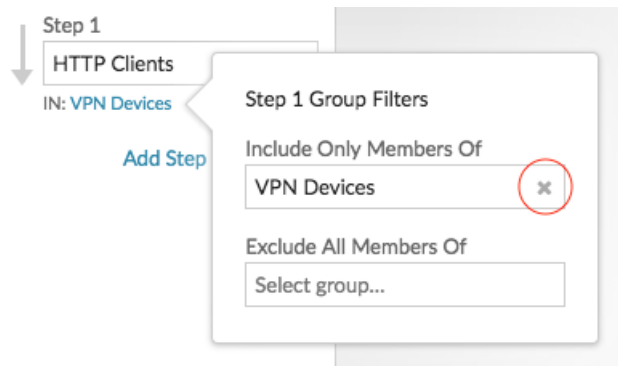

d) Click anywhere outside of the filter menu to apply your filter updates.

Next steps

- [Save and share activity map](#) 